

## **VFS 2 Adapter Tips**



## Using adapter tips with blue Delrin end piece

Adapter tips, which have a definite orientation such as the ASC shown in the illustration below, may have the blue end piece, which may be rotated to a convenient position.

To rotate the blue end piece perform the following steps:

- 1 Insert the blue end piece into the connector being inspected.
- 2 Hold the VFS 2 Probe and the black [base] portion of the adapter tip in one hand.
- 3 Hold the blue end piece and connector being inspected in the other hand.
- 4 The VFS 2 Probe and the [base] may now be rotated as one unit while the blue end piece is prevented from rotating.

**Example:** It may be convenient to have the Probe body pointed downward when inserted into a connector patch panel. Re-adjust as needed for different situations.

**Note:** The blue end-piece should not be removed from the adapter tip. When removing the adapter tip from the VFS 2 Probe, be sure to unscrew the black [base] as usual.

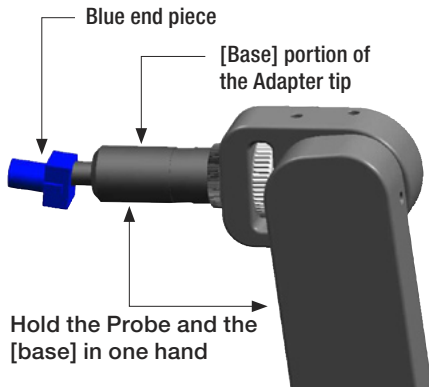

## Using the VFS 2 universal cap adapter

The VFS 2 universal cap adapter provides expanded options for inspection a wide variety of connector types. It must be handled with additional care beyond that given to the standard VFS 2 due to mechanical considerations. Please follow the instructions below when installing the universal cap adapter to the VFS 2 Probe and also when attaching each Noyes adapter cap to the universal cap adapter.

- 1 Thread the universal cap adapter into the VFS 2 Probe, and then tighten it using the knurled area at the Probe end (FINGER TIGHT ONLY!).
- 2 When attaching a Noyes adapter cap to the universal cap adapter, hold the straight section of the universal cap adapter firmly as each Noyes adapter cap is gently screwed onto the end.
- 3 Once installed, each Noyes adapter cap can be “panned” in any X-Y direction as follows:
  - Gently twist the engraved lock ring toward the unlock direction until it is only lightly snugged down.
  - As needed, move the installed Noyes adapter cap to center either the fiber end or to inspect adjacent areas of the ferrule.
  - If desired, the lock ring can then be gently turned in the lock direction to hold the position.
- 4 Removal of a Noyes adapter cap or the universal cap adapter itself is the reverse of the directions provided above.

**Note:** Use caution not to rotate the probe head against the probe body while the universal cap adapter is attached.



**Thank you for choosing Noyes Test & Inspection**

16 Eastgate Park Road  
Belmont, NH 03220  
Phone: 800-321-5298  
603-528-7780  
Fax: 603-528-2025



**[www.AFLtele.com](http://www.AFLtele.com) > Products > Noyes Test & Inspection**

